

Montaj Braketleri / Mounting Brackets

L Tipi Montaj Braketi / L Mounting Bracket

İL - XKL - ACF

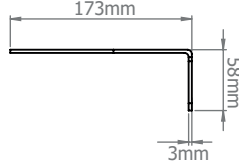
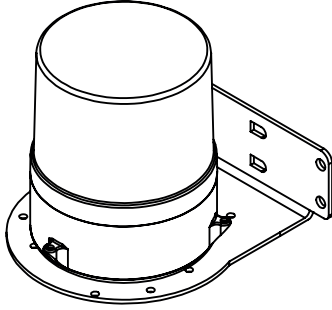

| | |
|----------------------|-----------------------------------|
| Material Material | Galvenize Sac Galvanized Sheet |
| Ağırlık Weight | 635 gr |

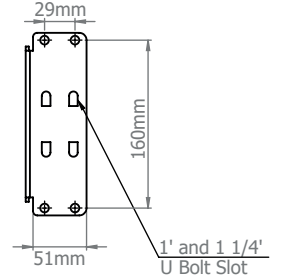
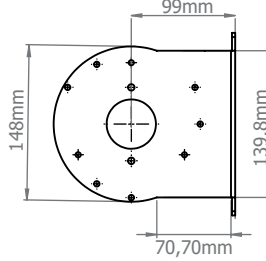

Taban Montaj Braketi / Base Mounting Bracket

İL - XKT. - ACF

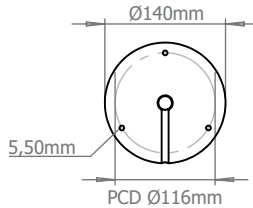
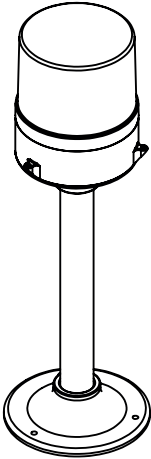

| | |
|----------------------------------|--|
| Taban Materyali Base Material | Alüminyum Aluminum |
| Boru Materyali Tube Material | RAL7030 Alüminyum RAL7030 Gray Aluminum |
| Ağırlık Weight | 430 gr |

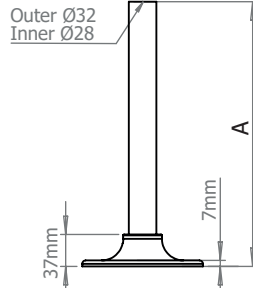

| | A |
|--------|--------|
| ..-KT | 47 mm |
| ..-KT1 | 107 mm |
| ..-KT2 | 207 mm |
| ..-KT3 | 307 mm |
| ..-KT4 | 407 mm |
| ..-KT5 | 507 mm |

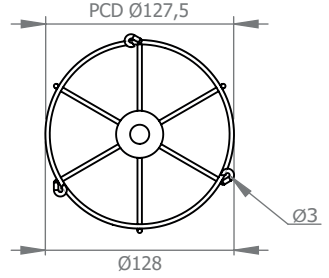
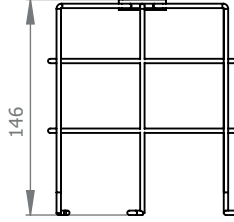
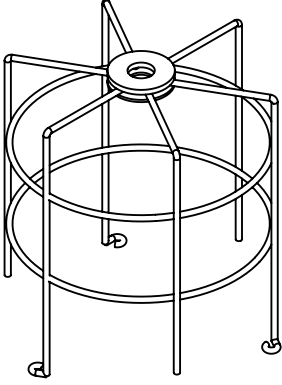
Koruma Kafesleri / Protection Cages**Darbe Koruma Kafesi / Impact Protection Cage****İL - XT10 - MK**

| | |
|----------------------|--|
| Materyal Material | RAL9005 Siyah Toz Boyalı Çelik RAL9005 Blackpowder Coated Steel |
| Ağırlık Weight | 125 gr |

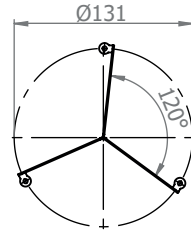
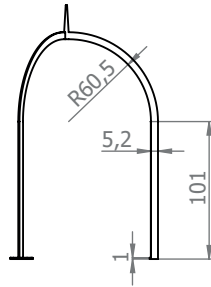
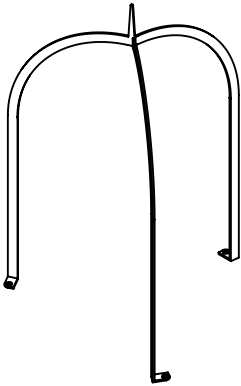
Kuş Kovucu Kafes / Bird Repellent Spike**İL - XT10 - MKD**

| | |
|----------------------|--|
| Materyal Material | RAL9005 Siyah Toz Boyalı Paslanmaz Çelik RAL9005 Blackpowder Stainless Coated Steel |
| Ağırlık Weight | 25 gr |