

# AIRCRAFT WARNING LIGHTS SERIES



Düşük Yoğunluk - Plastik  
Low Intensity - Plastic



Düşük Yoğunluk - Döküm  
Low Intensity - Cast



Yedekli Düşük Yoğunluk  
Low Intensity with Backup



Güneş Paneli Serisi  
Solar Series







Orta Yoğunluk  
Medium Intensity

## Genel Bilgiler / General Specifications

ILX Uçak İkaz Lambaları Serisi, hava araçlarının yerden yüksek noktaları tespit edebilmesi için gerekli standartlara uygun yerli üretim sistemlerdir. Sistem 480W'a kadar güç ve 10 adede kadar besleme çıkışı sağlayabilmektedir. Sistemde bulunan dahili fotosel ile gece düşük yoğunlukta 32cd ve orta yoğunlukta 2000 cd( $\pm$ %25) kırmızı ışık vermektedir. Sistemde bulunan kuru kontak arıza çıkışları ile ürünlerde meydana gelebilecek herhangi bir arıza anında tespit edilebilecektir.

ILX Aircraft Warning Light Series are domestic production systems that comply with standards required for aircraft to detect points high above the ground. The system can provide up to 480W power and up to 10 power outputs. With the internal photocell in the system, product emit 32cd at low intensity and 2000 cd ( $\pm$ 25) at low intensity at night. With the dry contact fault outputs in the system, any malfunction that may occur in the products can be detected immediately.

## Teknik Özellikler / Technical Specifications

	Düşük Yoğunluk <i>Low Intensity</i>		Yedeklemeli Düşük Yoğunluk <i>Low Intensity with Backup</i>	Orta Yoğunluk <i>Medium Intensity</i>	
					
	<b>İL-XACF-BP</b>	<b>İL-XACF-BD</b>	<b>İL-XACF-B2R</b>	<b>İL-XACF-MBD-24</b>	<b>İL-XACF-MBD-220</b>
Besleme Gerilimi <i>Voltage Supply</i>	12-24V DC 110-220V AC	12-24V DC 110-220V AC	12-24V DC 110-220V AC	24V DC	220V AC
Sinyal Tipi <i>Signal Type</i>	Flaşör / <i>Flashing</i> (20 fpm) Çakar / <i>Strobe</i> (160 fpm) Sürekli / <i>Continuous</i>	Flaşör / <i>Flashing</i> (20 fpm) Çakar / <i>Strobe</i> (160 fpm) Sürekli / <i>Continuous</i>	Flaşör / <i>Flashing</i> (20 fpm) Çakar / <i>Strobe</i> (160 fpm) Sürekli / <i>Continuous</i>	Flaşör (20 fpm) <i>Flashing</i> (20 fpm)	Flaşör (20 fpm) <i>Flashing</i> (20 fpm)
Işık Rengi <i>Light Color</i>	Kırmızı (ICAO Standardı) / <i>Red (ICAO Standard)</i>				
Işık Yoğunluğu <i>Luminous Intensity</i>	32 cd (Type B)	32 cd (Type B)	32 cd (Type B)	2000 ± %25 cd (Type B)	2000 ± %25 cd (Type B)
Işık Kaynağı <i>Luminous Source</i>	Power LED				
Fotosel <i>Photocell</i>	✓	✓	✓	✓	✓
Alarm Çıkışı <i>Alarm Output</i>	Normalde Kapalı Kuru Kontak / <i>Normally Closed Dry Contact</i>				
Güç Tüketimi <i>Power Consumption</i>	4,29W	4,29W	4,5W	60W	48W
Ağırlık <i>Weight</i>	320g	1025g	1720g	1050g	3000g
Gövde Materyali <i>Body Material</i>	ABS	Alüminyum Döküm / <i>Cast Aluminium</i>			
Lens Materyali <i>Lens Material</i>	Polikarbon / <i>Polycarbonate</i>				
Bağlantı <i>Connection</i>	Kablo / <i>Cable</i>				
Montaj Şekli <i>Mounting</i>	Taban Montaj Duvar Montaj <i>Base Mount Wall Mount</i>	Taban Montaj Duvar Montaj Boru Montaj <i>Base Mount Wall Mount Tube Mount</i>	Boru Montaj <i>Tube Mount</i>	Taban Montaj Duvar Montaj Boru Montaj <i>Base Mount Wall Mount Tube Mount</i>	Taban Montaj Duvar Montaj Boru Montaj <i>Base Mount Wall Mount Tube Mount</i>
Koruma Sınıfı <i>Protection Class</i>	IP65				
Çalışma Sıcaklığı <i>Temp. Range</i>	-20°C / +50°C				

## Solar Serisi / Solar Series



İL-XACSL-BP



İL-XACSL-BD



İL-XSL510

Güneş Paneli Gücü Solar Panel Power	1W	1W	5W
Sinyal Tipi Signal Type	Çakar (20 fpm) / Strobe (20 fpm)		Çakar (20 fpm) / Strobe (20 fpm) Sabit / Continuous
Işık Rengi Light Color	Kırmızı (ICAO Standardı) / Red (ICAO Standard)		
Işık Yoğunluğu Luminous Intensity	32 cd (Type B)		32 cd (Type B) 10 cd
Işık Kaynağı Luminous Source	Power LED		
Fotosel Photocell	✓	✓	✓
Alarm Çıkışı Alarm Output	Opsiyonel Optional		
Çalışma Süresi Operation Life	Güneş ışığı olmadan tam şarjda 70 saat 70 hours without sunlight at full charge		Red 10cd Continuous : 60h Red 32cd Continuous : 24h Red 10cd Strobe (60fpm) : 180h Red 32cd Strobe (60fpm) : 70h
Güç Tüketimi Power Consumption	<<1W		1,1W
Ağırlık Weight	320g	1025g	2500g
Gövde Materyali Body Material	ABS	Alüminyum Döküm / Cast Aluminium	Çelik / Steel
Lens Materyali Lens Material	Polikarbon / Polycarbonate		
Montaj Şekli Mounting	Taban Montaj / Base Mount Duvar Montaj / Wall Mount	Taban Montaj / Base Mount Duvar Montaj / Wall Mount	Taban Montaj / Base Mount Duvar Montaj / Wall Mount
Koruma Sınıfı Protection Class	IP65		
Çalışma Sıcaklığı Temp. Range	-20°C / +50°C		

## Bağlantı / Connection

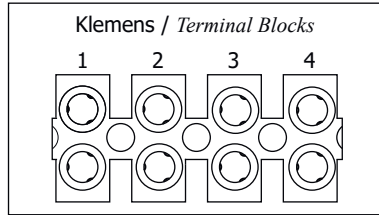
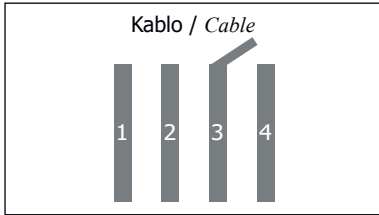

1	24VDC / 220VAC IN
2	GND / 220VAC IN
3	Dry Contact Alarm Output
4	Dry Contact Alarm Output

Kontrol kartı üzerinde bulunan buton yardımıyla düşük yoğunluklu uçak ikaz lambalarının modu değiştirilebilmektedir.

The mode of low intensity aircraft warning lights can be changed using the button on the control card.

## Kontrol Paneli Boyutları ve İç Görünüşü / Control Box Dimensions and Inside View

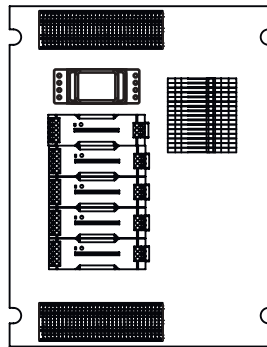
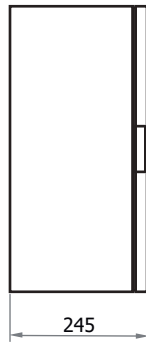
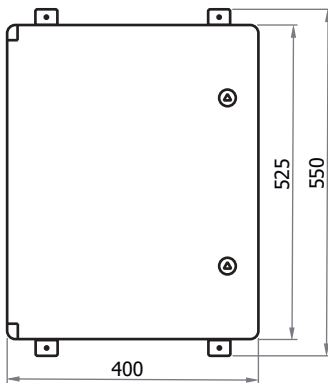

Panel Kodu Panel Code	Maksimum Besleme Gücü Max Supply Power
İL-XACF-PN1	240W
İL-XACF-PN2	480W

## Örnek Uygulama / Application Example

107m < H < 213m

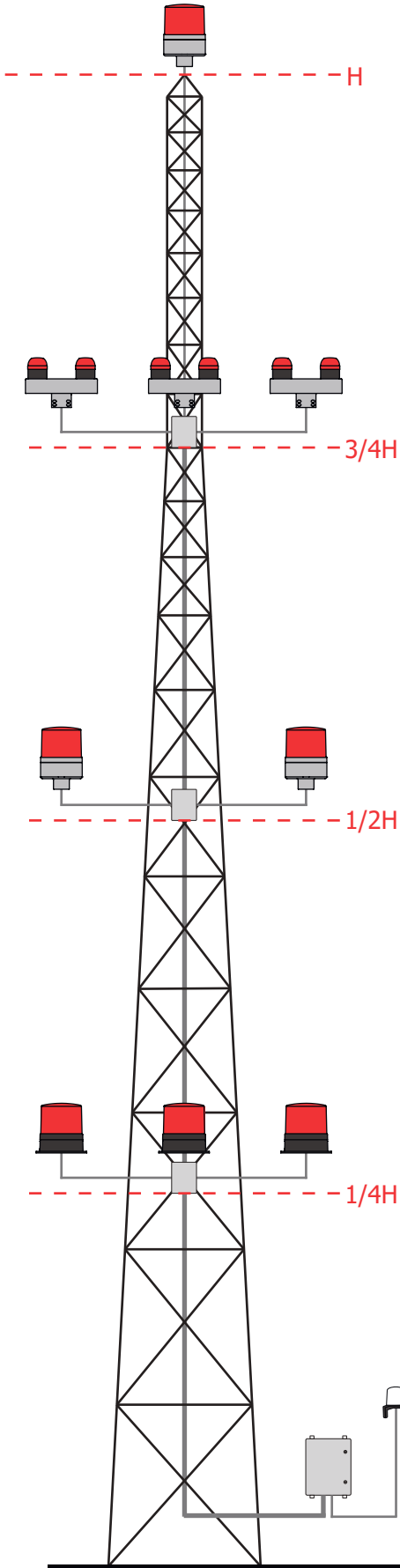







### Kullanım Alanları / Where to be used

				
Uzun Binalar Tall Buildings	Radyo Kuleleri Broadcast Masts	Elektrik Direkleri Electricity Pylons	Bacalar Chimneys	Rüzgar Türbinleri Wind Turbines

### Yükseklik / Height Kullanılması gereken lampa adedi / Number of lamps to be used

107-213m :	<ul style="list-style-type: none"> <li>• 3 orta yoğunluk uçak ikaz lambası</li> <li>• 8 düşük yoğunluk tekli veya yedeklemeli uçak ikaz lambası</li> <li>• 3 medium intensity aircraft warning lights</li> <li>• 8 single or backup low intensity aircraft warning lights</li> </ul>
45-107m :	<ul style="list-style-type: none"> <li>• 1 orta yoğunluk uçak ikaz lambası</li> <li>• 4 düşük yoğunluk tekli veya yedeklemeli uçak ikaz lambası</li> <li>• 1 medium intensity aircraft warning light</li> <li>• 4 single or backup low intensity aircraft warning lights</li> </ul>
0-45m :	<ul style="list-style-type: none"> <li>• 1 düşük yoğunluk tekli veya yedeklemeli uçak ikaz lambası</li> <li>• 1 single or backup low intensity aircraft warning lights</li> </ul>

### Semboller / Symbols

	Orta Yoğunluk (Tip B) Medium Intensity (Type B)
	Düşük Yoğunluk (Tip B) Low Intensity (Type B)
	Yedeklemeli Düşük Yoğunluk (Tip B) Low Intensity with Backup (Type B)
	Fotosel Photocell
	Kontrol Paneli Control Panel
	Junction Box Buat
	Kablo Cable

45m < H < 107m

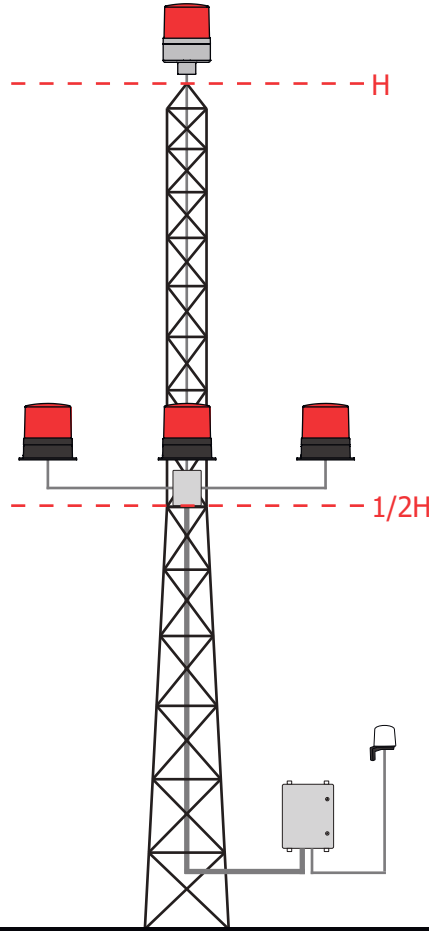

H < 45m

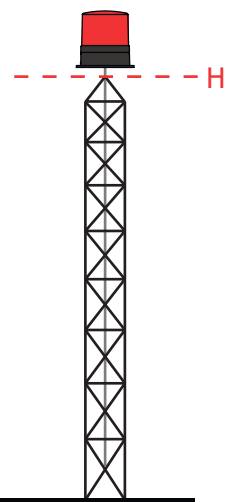

**Boyutlar / Dimensions**

**İL-XACF-BP, İL-XACSL-BP**

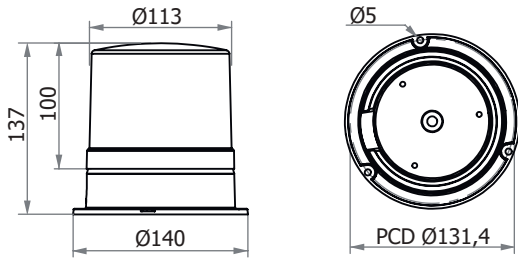

**İL-XACF-BD, İL-XACF-MBD-24, İL-XACSL-BD**

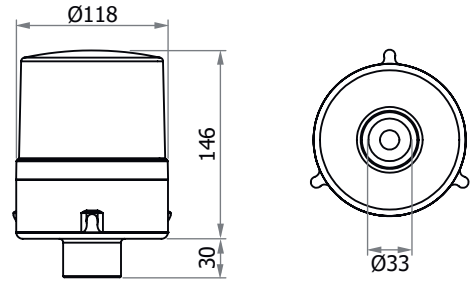

**İL-XACF-B2R**

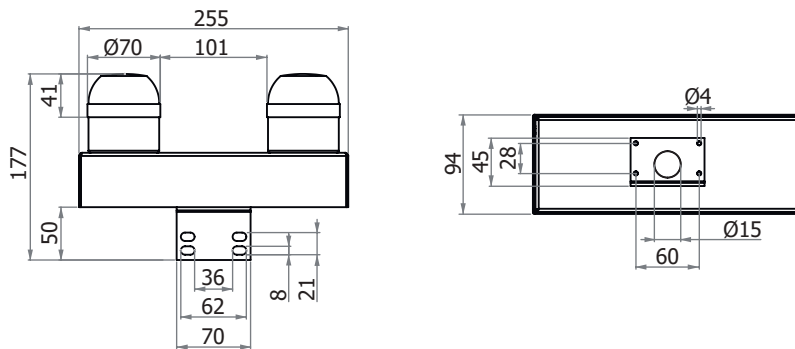

**İL-XACF-MBD-220**

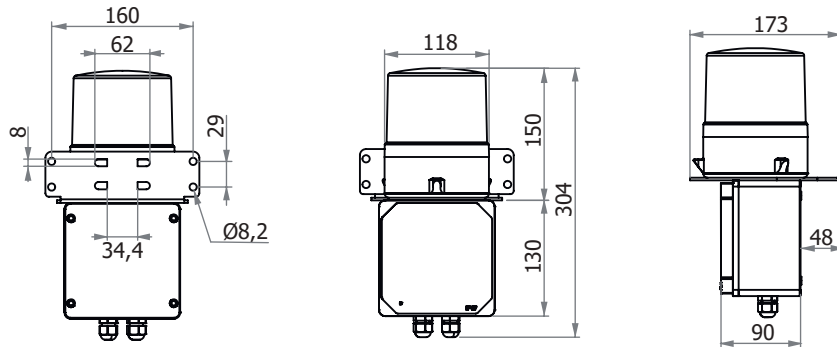

**İL-XSL510**

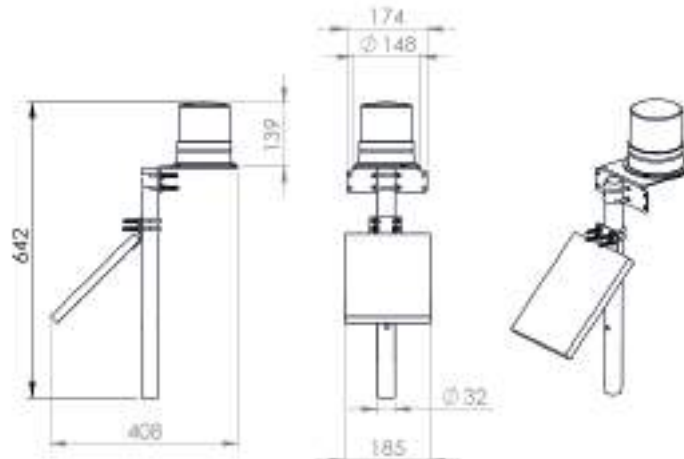

## Montaj Braketleri / Mounting Brackets

### L Tipi Montaj Braketi / L Mounting Bracket

İL - XKL - ACF

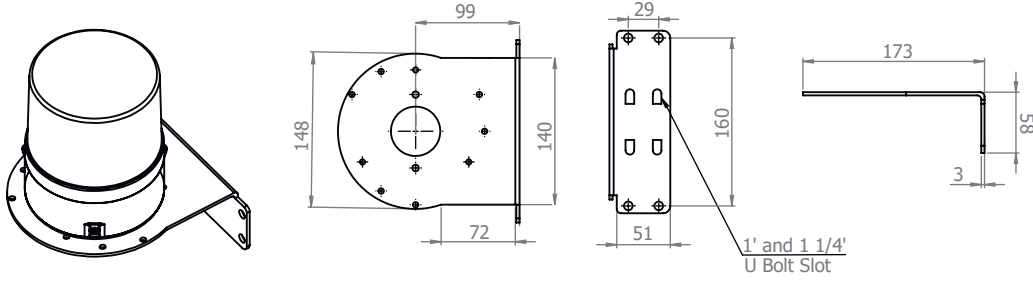

Materyal Material	Galvenize Sac Galvanized Sheet
Ağırlık Weight	635 gr

Bu montaj şekli B2R serisi ile kullanılamaz. / This mounting method cannot be used with B2R series.

### Taban Montaj Braketi / Base Mounting Bracket

İL - XKT. - ACF

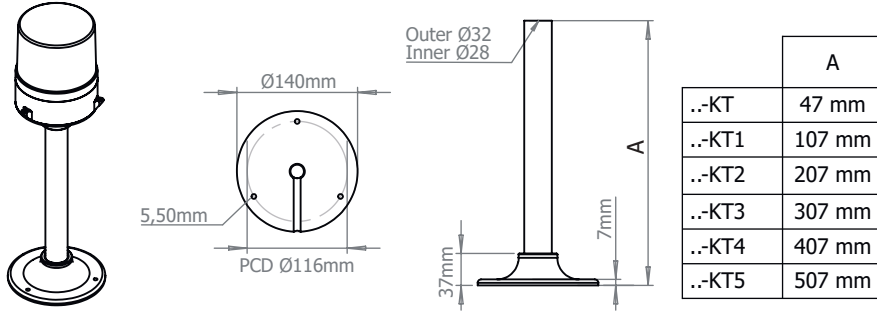

Taban Materyali Base Material	Alüminyum Aluminium
Boru Materyali Tube Material	RAL7030 Alüminyum RAL7030 Gray Aluminium
Ağırlık Weight	430 gr

Bu montaj şekli BP, B2R and MBD-220 serisi ile kullanılamaz. / This mounting method cannot be used with BP, B2R and MBD-220 series.

## Kod Tablosu / Code Table

For ACF Series

### İL - XACF - BD - 24K

AIRCRAFT WARNING LIGHT

**LIGHT COLOR**

**K** : Red (ICAO Standard) ●

**PRODUCT**

**BP** : Single Low Intensity with Plastic Body  
**BD** : Single Low Intensity with Cast Body  
**B2R** : Low Intensity with Backup  
**MBD** : Medium Intensity

**SUPPLY VOLTAGE**

**12** : 12 VDC (MBD serisi hariç kullanılabilir.  
Can be used except with MBD series)  
**24** : 24 VDC  
**11** : 110 VAC (MBD serisi hariç kullanılabilir.  
Can be used except with MBD series)  
**22** : 220 VAC

For Solar Series with 1W Panel

### İL - XACSL - BPK

SOLAR LIGHT with 1W Panel

**LIGHT COLOR**

**K** : Red (ICAO Standard) ●

**PRODUCT**

**BP** : Single Low Intensity with Plastic Body  
**BD** : Single Low Intensity with Cast Body

For Solar Series with 1W Panel

### İL - XSL510 - KMK

SOLAR LIGHT with 5W Panel

**LIGHT COLOR**

**K** : Red (ICAO Standard) ●

**PRODUCT**

**TM** : Base Mount  
**KM** : Tube Mount



www.ilx.com.tr



RoHS